

Profil Katalođu 2020  
Profile Catalogue



**ALCAS**<sup>®</sup>  
ALUMINIUM PROFILE SYSTEMS

# CEPHE SİSTEMLERİ

## Façade Systems

*World's new profile systems*





Factory / Üretim Tesisi / Çorlu - TEKİRDAĞ



1. Press Line / 2750 US Ton 1. Pres Hattı



2. Press Line / 1800 US Ton 2. Pres Hattı



3. Press Line / 1540 US Ton 3. Pres Hattı



**ALCAS®** Çorlu - Tekirdağ'da 42.000 m2 arazi üzerinde alüminyum üretimi için özel olarak inşa edilmiş 36.000 m2 kapalı alana sahip tesise sahip olup, uzman 270 personel görev almaktadır. Tesismizde 2.750 Ton 1800 Ton ve 1540 Ton olarak 3 ekstrüzyon presi bulunmaktadır. Yıllık üretim kapasitemiz 22.000 TON olup DU 10 mm'den DU 310 mm'e kadar her türlü profil üretimi yapılabilmektedir. Yüzey işlemsiz pres profilleri 13.6 m.'ye kadar termikleme, paketleme ve sevkiyat imkanı mevcuttur.

Eloksal tesismiz yıllık 11.000 ton profile eloksal yapma kapasitesine sahiptir. Eloksal banyolarımızın boyu 8 m olup net 7.60 cm. uzunluğa kadar olan profiller eloksal yapılabilmektedir. Tesismizde standart 12 mikron kaplamanın yanı sıra isteğe bağlı özel olarak 5 mikrondan 30 mikrona kadar eloksal işlemi yapılabilmektedir. Türkiye'nin en ileri teknolojisine sahip eloksal tesismizde polisajlı parlak profiller, satınel mat profiller ile gümüş, sarı, bronz, siyah renkli eloksalları aynı anda yapmak mümkün olmaktadır. Elektrostatik boya hattımız 36 m fırın uzunluğuna ve çift boya kabineye sahip olup yıllık 7.000 ton alüminyum profilin 180 çeşit RAL renklerinin boyanabildiği hattımızda 7.80 cm. uzunluğa kadar profiller boyanabilmektedir.

Alüminyum profil sistemlerimizin tüm kalıpları fabrikamız bünyesindeki kalıphanemizde gelişmiş CNC makinelerle ve ekipmanlarla donatılmış olup yıllık kalıp üretim kapasitemiz 1.400 adettir.

Firmamızın kendi AR-GE departmanında geliştirmekte olduğu sistemlerin kalıpları, büyük bir hassasiyetle üretilmekte çeşitli test aşamalarından sonra profil üretimine girilmektedir.

Kesme, delme, bükme, çapak alma, barkodlama gibi işlemlerin yapılabildiği gelişmiş makina parkına sahip konfeksiyon hattımızda, müşterilerimizin talep ettiği her türlü profil işleme işleri yapılmakta ve isteğe uygun olarak paketlenmektedir. İmalatımız da 6063,6060 ,6061,6005, 6082 alaşımı hammaddeden F18 den F31 e kadar çeşitli sertlikte ,su soğutmalı üretim yapabilmekteyiz. Ürettiğimiz tüm ürünler DIN 12020, 12021, 12022 normlarına uygundur.

Alüminyum giydirme cephe, kapı, pencere sektöründe uzman olan firmamızın tesismizdeki üretimini %65'i kapı, pencere, cephe profilleri gibi mimari ürünlerden oluşmaktadır. Mimar ve mühendislerden oluşan 12 kişilik teknik ekibimiz yeni sistemler üretmekte, varolan sistemleri de geliştirmektedir. Tüm sistemlerimiz çeşitli deneyler ve testlerden geçirilmekte sorunsuz ürünü size ulaştırmayı hedefleyen ARGE departmanımız sizlerden gelecek her türlü talebi hızla yerine getirmeye hazırdır. Üretimimizin %67'ini başta Amerika ve Avrupa ülkeleri olmak üzere 28 ülkeye ihraç eden firmamızın yurt içinde de 300'ü aşkın bayii ve kurumsal müşteriye hizmet vermektedir. Şirketimiz birçok ülkede bulunan bağılantı ve ofislerimiz vasıtasıyla hızlı, yerel ve güvenilir hizmet sunmaktadır.

TSE, GOST, GOST-R, CE, CPTP, ISO 9001:2008, QUALONAT, QUALICOAT, IFT ROSENHEIM, ISO 18001, ISO 14001, IATF 16949, EN 15088 gibi bir çok kalite ve standartlar belgesine sahip fabrikamızın yüksek kapasitesi, profil serilerindeki geniş yelpaze ve üretim tecrübesi ile sizlere en iyi profil ve profil sistemlerini sunmaya hazırdır.

**ALCAS®** ALUMINIUM PROFILE SYSTEMS 270 qualified personnel is working in the factory which is specially built and landed on a total area of 42.000 m2 and a closed area of 36.000 m2 in Çorlu Tekirdağ. We have two extrusion presses in the factory, 2.750 UST 1800 UST and 2540 UST. The annual production capacity is 22.000 tons and all kind of profiles which have width of 10 mm to 310 mm can be produced. Max. Mill Finish surface aged to T6 profile length is 13.6 meters.

Our anodic oxidation plant has got the capacity of making 11.000 tons of profile anodic oxidation annually. The length of our anodic oxidation baths is 8 meters and there the profiles till the length of 7.60 cm net can be made anodic oxidation. In our plant besides the standard 12 micron of coating, the anodic oxidation process from 5 micron to 30 micron depending on the request can be made peculiarly. It is possible to make polished luminous profiles, satin opaque profiles and silver, yellow, bronze, black colored anodic oxidations at the same time in our anodic oxidation plant having the latest technology of Turkey. Our electrostatic paint line has got an oven length of 3x6 meters and double paint cabins and the profiles until the length of 7.80 cm can be painted in our line in which 180 kinds of RAL colors of 7.000 tons of aluminum profiles can be painted.

All the moulds of our aluminum profile systems are made with the developed CNC machine tools and equipments in our molding room present within the constitution of our factory and our annual capacity of mould production is 1.400 pieces. The molds of the systems which are developed in its own Research & Development department of our firm are produced with great precision and the profile production is started following various test stages. All kinds of profile processing works requested by our

customers are made in our confection line having the developed machinery line where the processes such as cutting, boring, bending, burr removing, bar coding can be made and are packed in conformity with the demand.

We can make water cooled production in various hardness in our production from 18 to 31 of the 6063, 6060, 6061, 6005, 6082 alloyed raw materials. All the products that we produce are in conformity with the norms of DIN 12020, 12021, 12022.55% of the production in our plant of our firm that is experienced in the aluminum curtain wall, door, window sectors consist of the architectural products such as doors, windows, face wall profiles. Our technical team of 12 persons consisted of Architectures and Engineers produce new systems and change the currently existing systems. All of our systems are being passed through various experiments and tests and our Development & Search department which aims to reach the products without any problem to you, is ready to perform any kind of demand to be received from you rapidly. Our company which exports 70% of its production to 28 countries to the European countries and USA at the first hand also has been giving service to vendors and corporate customers exceeding 300 inside the country. Our company, through our offices in many countries, and the connection fast, local and reliable service provides.

Our factory, which has got a lot of certificates of quality and standards like TSE, GOST, GOST-R, CE, CPTP, ISO, QUALONAT, QUALICOAT, IFT ROSENHEIM, ISO 18001, ISO 14001, IATF 16949, EN 15088 is ready to submit you the best profiles and profile systems along with its high capacity, its wide range at the profile series and the production experience.

Shipping and Packaging / Sevkiyat ve Paketleme

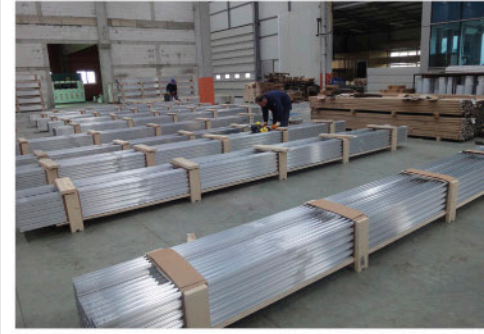

Shipping and Packaging / Sevkiyat ve Paketleme



Die Shop / Kalıphane



Mechanical Processes / Mekanik İşlemler



Electrostatic Paint Line / Elektrostatik Boya Hattı



Anodizing Line / Eloksal Hattı



Die Archive / Kalıp Arşivi



Wood Coating Unit / Ahşap Kaplama Ünitesi

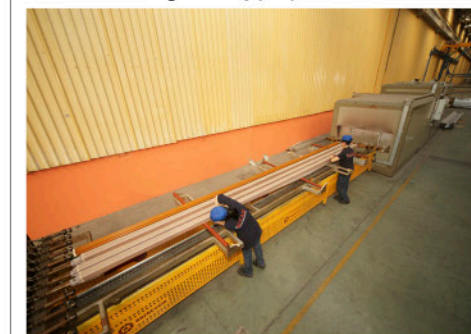

Mechanical Processes / Mekanik İşlemler



Project Name / Proje Adı : Olimpa AVM  
 System / Sistem : AF68 SKY  
 City / Şehir : Başakşehir - İstanbul - TÜRKİYE

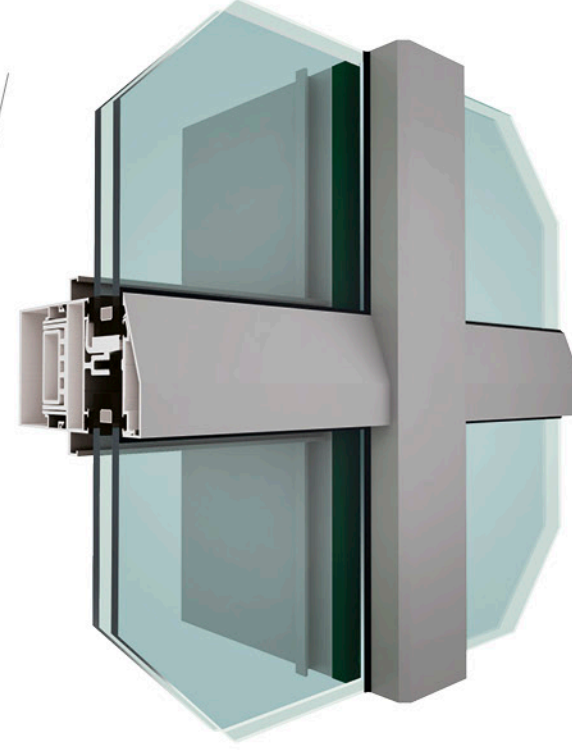

# AF68 SKY

Alcas Facade Skylight Systems  
 Alcas Çatı Işıklık Sistemleri

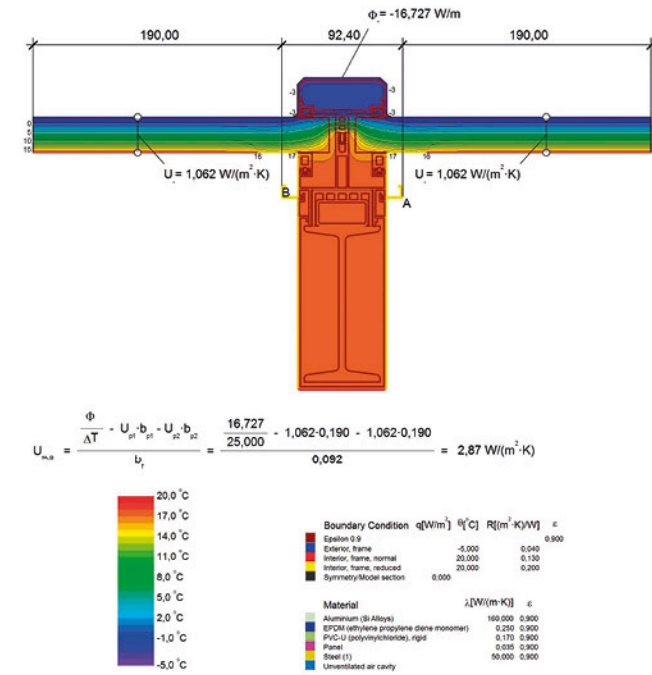

Binalarda ferah ve konforlu mekanlar oluşturmak için tasarlanmış **ALCAS** ışıklık sistemi, her türlü açı ve şekildedeki çatı ışıklık projelerini çözebilecek mulyon ve transomlara sahiptir. Sistem genişliği 68 mm olup özel olarak tasarlanmış kondens kanalları sayesinde dışarıdan sızabilecek yağmur ve kar suyunu, aynı zamanda içerde oluşan yoğunlaşma suyunu tahliye edebilme özelliğine sahiptir, Çelik takviyeli yapısı ile büyük açıklıklar geçebilmektedir.

**ALCAS** ışıklık sistemi iç mekanların rahat havalandırılması, herhangi bir yangın durumunda duman tahliyesi için özel olarak tasarlanmış kanat yapısı, motor ve farklı sensör seçenekleri ile konforlu ve güvenli bir sistem sunmaktadır.

**ALCAS** SKYLIGHT SYSTEM is designed to form comfortable places and this system includes mullion and transom profiles to solve all types of angle and shape of skylight projects. The width of the system is 68 mm and this system has the ability to drain out the rain and snow water leakages and condensate water coming inside the building thanks to the specially designed condensation channels. The steel reinforced structure assures installation on bigger distances.

**ALCAS** SKYLIGHT SYSTEM is very comfortable and safe, because this system has specially designed wing structure, motor system and different sensor types to achieve a good air conditioning of the places and smoke draining in case of a fire.

### Descriptions / Tanımlamalar

| Profile type description    |                    |
|-----------------------------|--------------------|
| <b>A</b> Brand <b>ALCAS</b> | Marka <b>ALCAS</b> |
| <b>F</b> System Type Facade | Sistem Tipi Ceph   |
| <b>50</b> Series Length     | Seri Genişliği     |
| <b>R</b> Profile Type       | Profil Tipi        |
| <b>01</b> Group Location    | Gruptaki Yeri      |
| <b>M</b> Mullion            | Mulyon             |
| <b>T</b> Transom            | Transom            |
| <b>V</b> Vent               | Kanat              |
| <b>A</b> Adapter            | Adaptör            |
| <b>C</b> Cover              | Kapak              |

### Symbols / Semboller

|  |  |
|--|--|
|  | Corner block assembly with 45° cutting process<br>45° kesim işlemi köşe takozu ile birleştirme         |
|  | Milling process of merging with the vertical connection<br>Kertme işlemi diik bağlantı ile birleştirme |
|  | Cross-sectional aspect of strength<br>Mukavemet kesit yönü   |

**ALCAS**

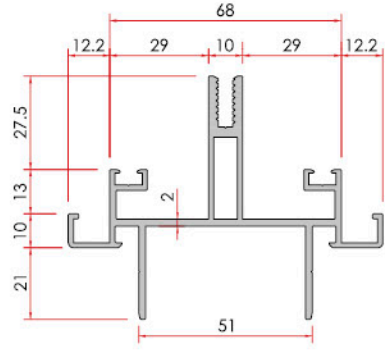

**Mullion**  
Mulyon

| System Code         | Profile No | Weight kg           |      |
|---------------------|------------|---------------------|------|
| AF68 M 02           | 1072       | 1.664               |      |
| Jxx cm <sup>2</sup> | 17.5       | Jyy cm <sup>2</sup> | 37.2 |

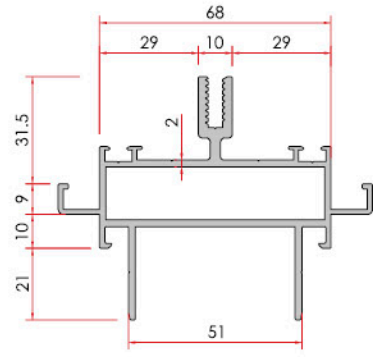

**Transom**  
Transom

| System Code         | Profile No | Weight kg           |      |
|---------------------|------------|---------------------|------|
| AF68 T 02           | 1074       | 1.837               |      |
| Jxx cm <sup>2</sup> | 18.7       | Jyy cm <sup>2</sup> | 40.8 |

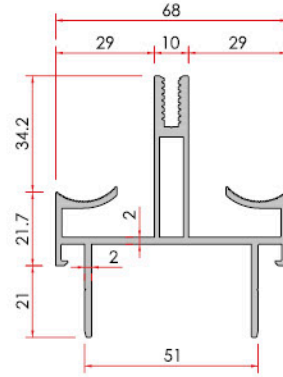

**Mullion**  
Mulyon

| System Code         | Profile No | Weight kg           |      |
|---------------------|------------|---------------------|------|
| AF68 M 03           | 1155       | 1.595               |      |
| Jxx cm <sup>2</sup> | 24.4       | Jyy cm <sup>2</sup> | 19.4 |

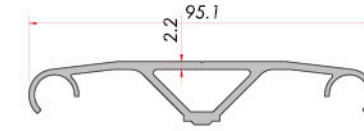

**Cover**  
Baskı Kapak

| System Code | Profile No | Weight kg |
|-------------|------------|-----------|
| AF68 C 10   | 1154       | 0.932     |

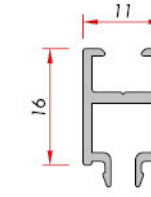

**Single Glass Bead**  
Tek Cam Çıtası

| System Code | Profile No | Weight kg |
|-------------|------------|-----------|
| AF50 A 03   | 1021       | 0.184     |

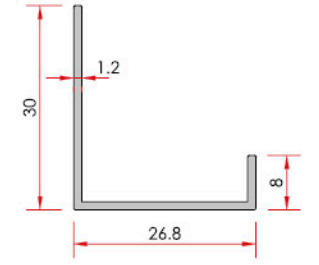

**Dilatation Profile**  
Dilatasyon Profili

| System Code | Profile No | Weight kg |
|-------------|------------|-----------|
| AF68 A 01   | 1156       | 0.202     |

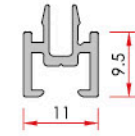

**Single Glass Bead**  
Tek Cam Çıtası

| System Code | Profile No | Weight kg |
|-------------|------------|-----------|
| AF50 A 18   | 1106       | 0.141     |

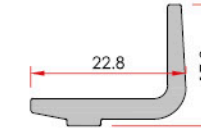

**Glazing Cleat**  
Cam Takozu

| System Code | Profile No | Weight kg |
|-------------|------------|-----------|
| 1100        | 1100       | 0.271     |

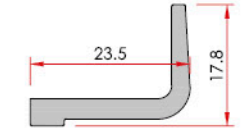

**Glazing Cleat**  
Cam Takozu

| System Code | Profile No | Weight kg |
|-------------|------------|-----------|
| 1101        | 1101       | 0.284     |

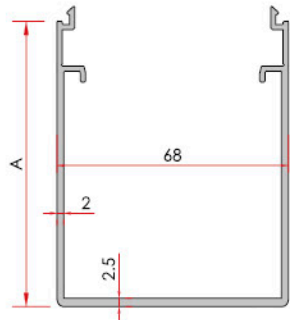

**Bottom Cover Profile**  
Alt Kapak Profili

| A      | System Code | Profile No | Weight kg/m |
|--------|-------------|------------|-------------|
| 50 mm  | AF68 C 04   | 1077       | 0.995       |
| 87 mm  | AF68 C 07   | 1076       | 1.485       |
| 147 mm | AF68 C 03   | 1075       | 2.452       |
| 240 mm | AF68 C 09   | 1195       | 4.008       |

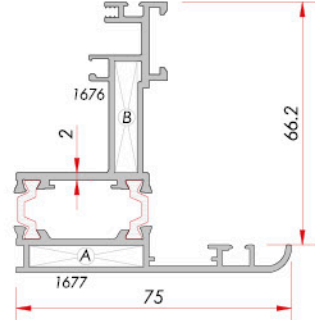

**Skylight Frame**  
Işıklı Kasa

| System Code         | Profile No   | Weight kg           |      |
|---------------------|--------------|---------------------|------|
| AF68SKY V 02        | 1676-1677    | 1.710               |      |
| Jxx cm <sup>2</sup> | 28.8         | Jyy cm <sup>2</sup> | 15.8 |
| A                   | AKB-1329-5.6 |                     |      |
| B                   | AKB-1097-30  |                     |      |

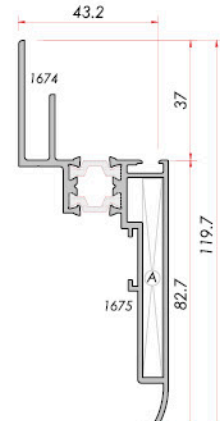

**Skylight Vent**  
Işıklı Kanat

| System Code         | Profile No    | Weight kg           |     |
|---------------------|---------------|---------------------|-----|
| AF68SKY V 01        | 1674-1675     | 1.551               |     |
| Jxx cm <sup>2</sup> | 38.6          | Jyy cm <sup>2</sup> | 9.3 |
| A                   | AKB-1097-61.4 |                     |     |

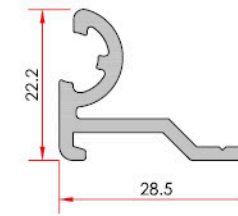

**Corner**  
Köşe Dönüş İç

| System Code | Profile No | Weight kg |
|-------------|------------|-----------|
| AF50 A 06   | 1040       | 0.347     |

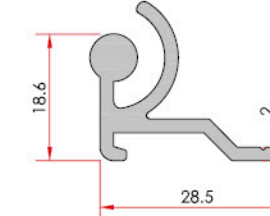

**Corner**  
Köşe Dönüş Dış

| System Code | Profile No | Weight kg |
|-------------|------------|-----------|
| AF50 A 07   | 1041       | 0.350     |

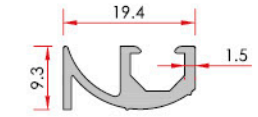

**Mulyon Angle Adapter Adjustment**  
Mulyon Açı Ayar Adaptörü

| System Code | Profile No | Weight kg |
|-------------|------------|-----------|
| AF68 A 02   | 1157       | 0.194     |

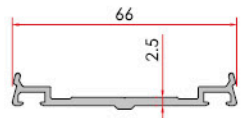

**Cover**  
Baskı Kapak

| System Code | Profile No | Weight kg |
|-------------|------------|-----------|
| AF68 C 02   | 1079       | 0.508     |

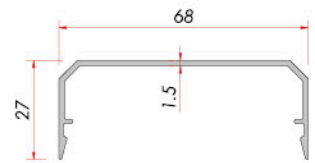

**Vertical Cover**  
Düşey Kapak

| System Code | Profile No | Weight kg |
|-------------|------------|-----------|
| AF68 C 01   | 1078       | 0.484     |

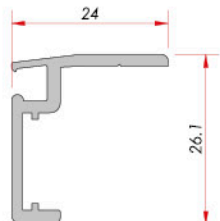

**Skylight Vent Adapter**  
Işıklı Kanat Adaptörü

| System Code  | Profile No | Weight kg |
|--------------|------------|-----------|
| AF68SKY A 01 | 1673       | 0.286     |

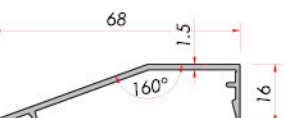

**Cover**  
Yatay Kapak

| System Code | Profile No | Weight kg |
|-------------|------------|-----------|
| AF68 C 05   | 1080       | 0.369     |

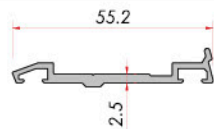

**Single Glass Bead**  
Tek Cam Çıtası

| System Code | Profile No | Weight kg |
|-------------|------------|-----------|
| AF68 C 06   | 1081       | 0.413     |

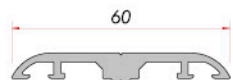

**Cover**  
Baskı Kapak

| System Code | Profile No | Weight kg |
|-------------|------------|-----------|
| AF68 C 08   | 1099       | 0.628     |



**Cover Angle Adapter Adjustment**  
Kapak Açı Ayar Adaptörü

| System Code | Profile No | Weight kg |
|-------------|------------|-----------|
| AF68 A 03   | 1158       | 0.137     |

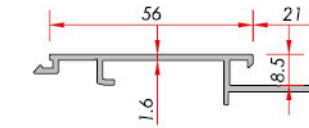

**Valve Adapter**  
Kapak Adaptörü

| System Code | Profile No | Weight kg |
|-------------|------------|-----------|
| AF68 A 04   | 1445       | 0.521     |

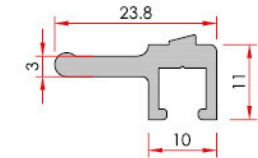

**Clip**  
Klips

| System Code | Profile No | Weight kg |
|-------------|------------|-----------|
| AF68 A 11   | 1107       | 0.294     |

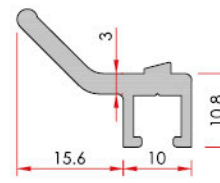

**Ext. Corner Turning Clips**  
Dış Köşe Dönüş Klipsi

| System Code | Profile No | Weight kg |
|-------------|------------|-----------|
| AF50 A 13   | 1114       | 0.328     |

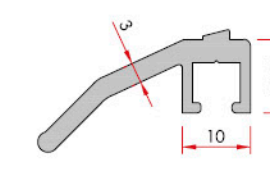

**Int. Corner Turning Clips**  
İç Köşe Dönüş Klipsi

| System Code | Profile No | Weight kg |
|-------------|------------|-----------|
| AF50 A 14   | 1112       | 0.382     |

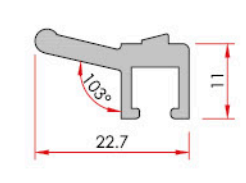

**Angle Clips**  
Açılı Klips

| System Code | Profile No | Weight kg |
|-------------|------------|-----------|
| AF50 A 19   | 1164       | 0.286     |



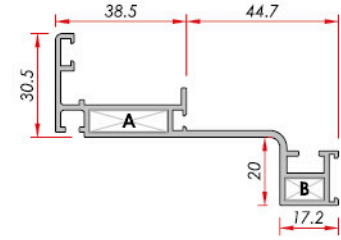

**Hidden Wing Frame**  
Gizli Kanat Kasa Panel

| System Code | Profile No  | Weight kg |
|-------------|-------------|-----------|
| AF50 V 03   | 1022        | 1.008     |
| A           | AKB-1097-22 |           |
| B           | AKB-1097-10 |           |

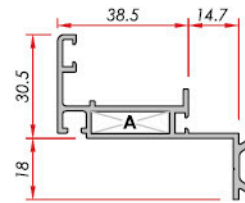

**Hidden Wing Frame**  
Gizli Kanat Kasa

| System Code | Profile No    | Weight kg |
|-------------|---------------|-----------|
| AF50 V 09   | 1096          | 0.706     |
| A           | AKB-1097 - 22 |           |
| B           | ---           |           |

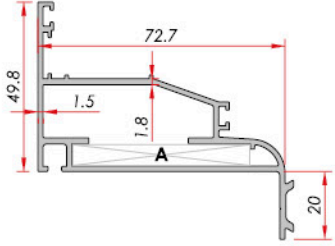

**Hidden Wing Frame**  
Gizli Kanat Kasa Panel

| System Code | Profile No  | Weight kg |
|-------------|-------------|-----------|
| AF50 V 21   | 1171        | 1.201     |
| A           | AKB-1097-51 |           |
| B           | ---         |           |

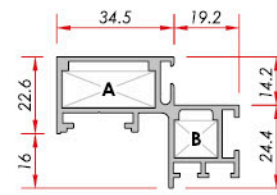

**Bonding Lath Narrow Glass Panel (Vent)**  
Bonding Çıtalı Dar Cam Paneli (Kanat)

| System Code | Profile No  | Weight kg |
|-------------|-------------|-----------|
| AF50 V 16   | 1049        | 0.883     |
| A           | AKB-1034-26 |           |
| B           | AKB-1034-12 |           |

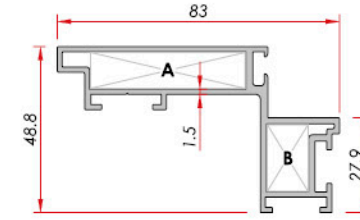

**Bonding Lath Glass Panel (Sash)**  
Bonding Çıtalı Cam Paneli (Kanat)

| System Code | Profile No  | Weight kg |
|-------------|-------------|-----------|
| AF50 V 20   | 1172        | 1.235     |
| A           | AKB-1034-45 |           |
| B           | AKB-1730-11 |           |

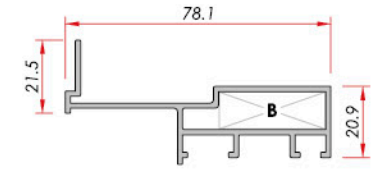

**Composite Panel**  
Kompoze Panel

| System Code | Profile No  | Weight kg |
|-------------|-------------|-----------|
| AF50 V 13   | 1149        | 0.825     |
| A           | ---         |           |
| B           | AKB-1034-30 |           |

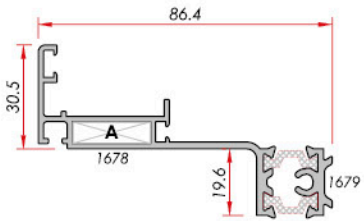

**Hidden Wing Frame**  
Gizli Kanat Kasa Panel

| System Code | Profile No    | Weight kg |
|-------------|---------------|-----------|
| AF50 V 22   | 1679-1678     | 1.303     |
| A           | AKB-1097 - 22 |           |
| B           | ---           |           |

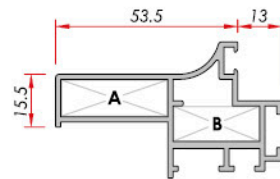

**Glazing Panel (Vent)**  
Cam Paneli (Kanat)

| System Code | Profile No  | Weight kg |
|-------------|-------------|-----------|
| AF50 V 01   | 1010        | 0.998     |
| A           | AKB-1034-30 |           |
| B           | AKB-1034-24 |           |

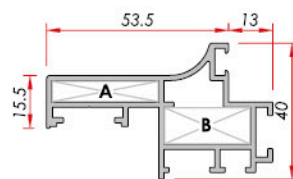

**Glazing Panel (Vent)**  
Cam Paneli (Kanat)

| System Code | Profile No  | Weight kg |
|-------------|-------------|-----------|
| AF50 V 14   | 1150        | 1.020     |
| A           | AKB-1097-30 |           |
| B           | AKB-1034-24 |           |

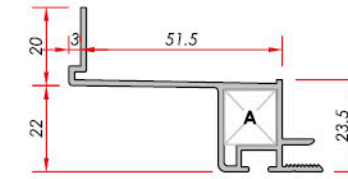

**Composite Panel**  
Kompoze Panel

| System Code | Profile No  | Weight kg |
|-------------|-------------|-----------|
| AF50 V 18   | 1197        | 0.635     |
| A           | AKB-1328-12 |           |
| B           | ---         |           |

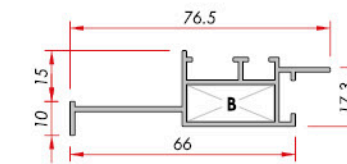

**Composite Panel**  
Kompoze Panel

| System Code | Profile No  | Weight kg |
|-------------|-------------|-----------|
| AF50 V 08   | 1087        | 0.635     |
| A           | ---         |           |
| B           | AKB-1034-24 |           |

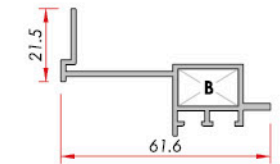

**Composite Panel**  
Kompoze Panel

| System Code | Profile No  | Weight kg |
|-------------|-------------|-----------|
| AF50 V 11   | 1121        | 0.583     |
| A           | ---         |           |
| B           | AKB-1034-16 |           |

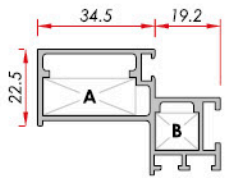

**Glazing Panel (Vent)**  
Cam Paneli (Kanat)

| System Code | Profile No  | Weight kg |
|-------------|-------------|-----------|
| AF50 V 12   | 1131        | 0.805     |
| A           | AKB-1034-26 |           |
| B           | AKB-1034-12 |           |

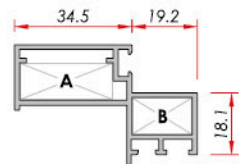

**Glazing Panel (Vent)**  
Cam Paneli (Kanat)

| System Code | Profile No  | Weight kg |
|-------------|-------------|-----------|
| AF50 V 07   | 1085        | 0.702     |
| A           | AKB-1034-26 |           |
| B           | AKB-1034-16 |           |

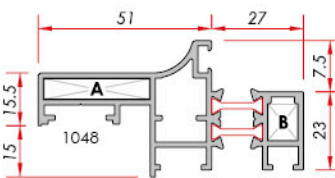

**Narrow Glass Panel (Vent)**  
Dar Cam Paneli (Kanat)

| System Code | Profile No  | Weight kg |
|-------------|-------------|-----------|
| AF50 V 19   | 1024-1048   | 1.382     |
| A           | AKB-1097-30 |           |
| B           | AKB-1034-8  |           |

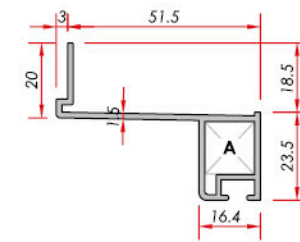

**Single Glass Panel**  
Tek Cam Paneli

| System Code | Profile No  | Weight kg |
|-------------|-------------|-----------|
| AF50 V 17   | 1196        | 0.570     |
| A           | AKB-1328-12 |           |
| B           | ---         |           |

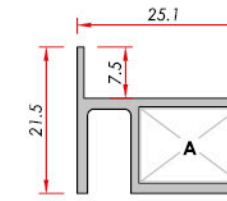

**Single Glass Panel**  
Tek Cam Paneli

| System Code | Profile No  | Weight kg |
|-------------|-------------|-----------|
| AF50 V 10   | 1109        | 0.309     |
| A           | AKB-1034-14 |           |
| B           | ---         |           |

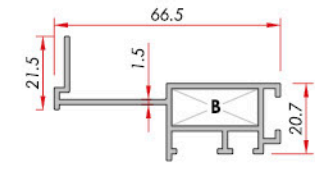

**Spandrel Panel**  
Spandrel Paneli

| System Code | Profile No    | Weight kg |
|-------------|---------------|-----------|
| AF50 V 02   | 1045          | 0.723     |
| A           | ---           |           |
| B           | AKB-1034 - 24 |           |

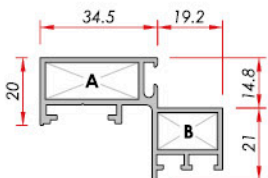

**Narrow Glass Panel (Vent)**  
Dar Cam Paneli (Kanat)

| System Code | Profile No  | Weight kg |
|-------------|-------------|-----------|
| AF50 V 15   | 1151        | 0.772     |
| A           | AKB-1034-26 |           |
| B           | AKB-1034-16 |           |

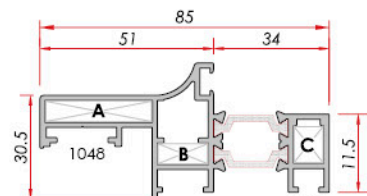

**Insulated Glazing Panel (Sash)**  
Yalıtımlı Cam Paneli (Kanat)

| System Code | Profile No  | Weight kg |
|-------------|-------------|-----------|
| AF50 V 23   | 1024-1048   | 1.457     |
| A           | AKB-1097-30 |           |
| B           | AKB-1097-14 |           |
| C           | AKB-1034-8  |           |

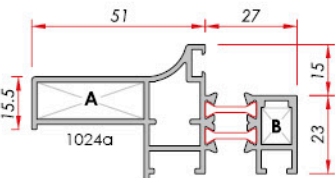

**Insulated Glazing Panel (Sash)**  
Yalıtımlı Cam Paneli (Kanat)

| System Code | Profile No    | Weight kg |
|-------------|---------------|-----------|
| AF50 V 05   | 1024-1024a    | 1.210     |
| A           | AKB-1034 - 30 |           |
| B           | AKB-1097 - 8  |           |

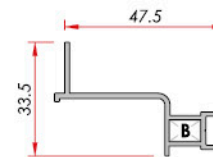

**Spandrel Panel**  
Spandrel Paneli

| System Code | Profile No   | Weight kg |
|-------------|--------------|-----------|
| AF50 V 04   | 1023         | 0.408     |
| A           | ---          |           |
| B           | AKB-1097 - 8 |           |

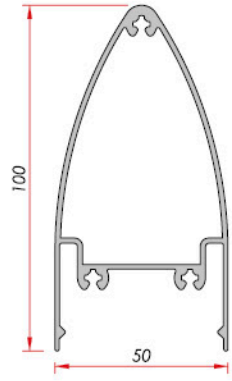

Cover  
Badem Kapak

| System Code | Profile No | Weight kg |
|-------------|------------|-----------|
| AF50 C 01   | 1015       | 1.365     |

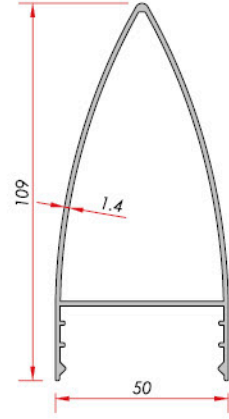

Cover  
Badem Kapak

| System Code | Profile No | Weight kg |
|-------------|------------|-----------|
| AF50 C 10   | 1184       | 1.100     |

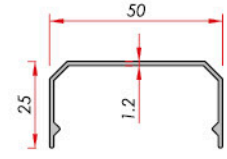

Cover  
Dikey Kapak

| System Code | Profile No | Weight kg |
|-------------|------------|-----------|
| AF50 C 02   | 1016       | 0.330     |

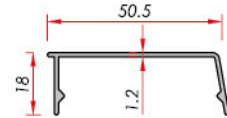

Cover  
Yatay Kapak

| System Code | Profile No | Weight kg |
|-------------|------------|-----------|
| AF50 C 03   | 1017       | 0.294     |

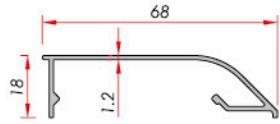

Skylight Cover  
Skylight Kapak

| System Code | Profile No | Weight kg |
|-------------|------------|-----------|
| AF50 C 04   | 1018       | 0.385     |

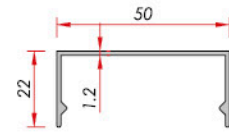

Cover  
Dikey Kapak

| System Code | Profile No | Weight kg |
|-------------|------------|-----------|
| AF50 C 07   | 1046       | 0.326     |

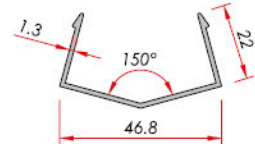

Cover  
Kapak

| System Code | Profile No | Weight kg |
|-------------|------------|-----------|
| AF50 C 09   | 1068       | 0.333     |

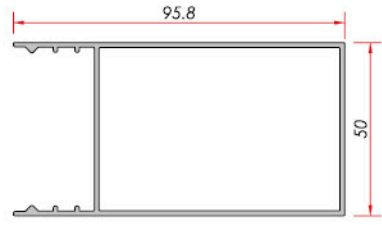

Cover  
Dikey Kapak

| System Code | Profile No | Weight kg/m |
|-------------|------------|-------------|
| AF50 C 12   | 1173       | 1.107       |

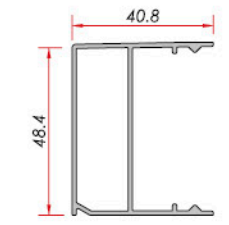

Cover  
Yatay Kapak

| System Code | Profile No | Weight kg/m |
|-------------|------------|-------------|
| AF50 C 13   | 1174       | 0.615       |

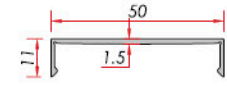

Cover  
Dikey Kapak

| System Code | Profile No | Weight kg/m |
|-------------|------------|-------------|
| AF50 C 15   | 1175       | 0.260       |

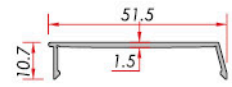

Cover  
Yatay Kapak

| System Code | Profile No | Weight kg |
|-------------|------------|-----------|
| AW50 C 16   | 1177       | 0.255     |

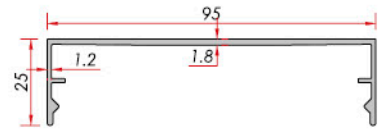

Cover  
Dikey Kapak

| System Code | Profile No | Weight kg |
|-------------|------------|-----------|
| AF50 C 18   | 1178       | 0.670     |

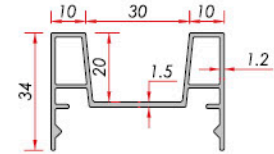

Cover  
Fugalı Kapak

| System Code | Profile No | Weight kg |
|-------------|------------|-----------|
| AF50 C 19   | 2057       | 0.630     |

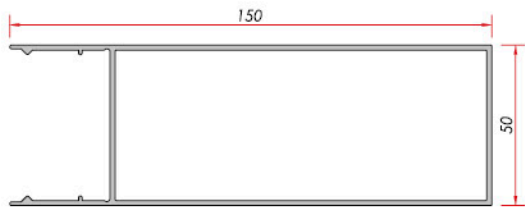

Cover  
Kapak

| System Code | Profile No | Weight kg |
|-------------|------------|-----------|
| AW50 C 20   | 1199       | 1.768     |

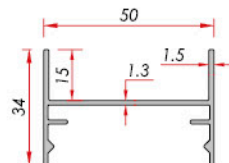

Cover  
Fugalı Kapak

| System Code | Profile No | Weight kg |
|-------------|------------|-----------|
| AW50 C 21   | 1879       | 0.485     |

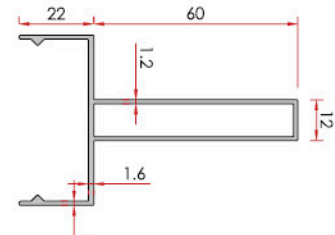

Cover  
Dikey Kapak

| System Code | Profile No | Weight kg |
|-------------|------------|-----------|
| AW50 C 28   | 5102       | 0.814     |

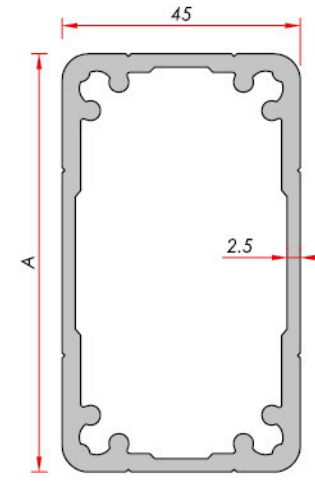

2 mm Mullion Dilatation  
2 mm Mulyon Dilatasyon

| A        | System Code | Profile No | Weight kg/mt | Jxx cm4 | Jyy cm4 | Mullion Profile<br>Mulyon Profili                    |
|----------|-------------|------------|--------------|---------|---------|--|
| 59.5 mm  | 1032        | 1032       | 1.905        | 34.5    | 21.0    | AF50 M 03<br>AF50 M 1803<br>AF50 EM 04<br>AF50 MH 03 |
| 79 mm    | 1031        | 1031       | 2.238        | 70.9    | 26.4    | AF50 M 02<br>AF50 M 1802<br>AF50 MH 04<br>AF50 EM 03 |
| 103.5 mm | 1030        | 1030       | 2.508        | 133.8   | 31.1    | AF50 M 01<br>AF50 M 1801<br>AF50 EM 02<br>AF50 MH 01 |
| 128 mm   | 1088        | 1088       | 2.851        | 226.8   | 36.6    | AF50 M 09<br>AF50 EM 01<br>AF50 MH 05                |

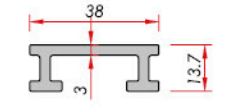

Half Mullion Dilatation  
Yarım Mulyon Dilatasyon

| System Code | Profile No | Weight kg |
|-------------|------------|-----------|
| 1027        | 1027       | 0.586     |

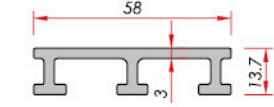

Half Mullion Dilatation  
Yarım Mulyon Dilatasyon

| System Code | Profile No | Weight kg |
|-------------|------------|-----------|
| 1028        | 1028       | 0.889     |

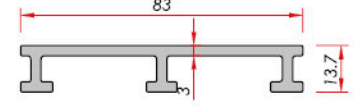

Half Mullion Dilatation  
Yarım Mulyon Dilatasyon

| System Code | Profile No | Weight kg |
|-------------|------------|-----------|
| 1029        | 1029       | 1.086     |

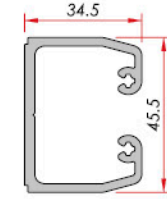

Mullion Dilatation  
Mulyon Dilatasyon

| System Code | Profile No | Weight kg |
|-------------|------------|-----------|
| 1033        | 1033       | 1.059     |

| Cutting Size<br>Kesim Ölçüsü       | 25 mm                    | 40 mm                     | 55 mm   | 70 mm  | 90 mm                                 | 95 mm     | 100 mm      | 110 mm   | 145 mm    |
|------------------------------------|--------------------------|---------------------------|---|--|---------------------------------------|-----------|-------------|--|-----------|
| Transom Profile<br>Transom Profili | AF 50 T 04<br>AF50 TH 05 | AF50 LM 02<br>AF50 M 1804 | AF50 T 03<br>AF50 T 08<br>AF50 ET 04<br>AF50 TH 01<br>AF50 M 1803 | AF50 T 02<br>AF50 ET 03<br>AF50 TH 02<br>AF50 LM 01<br>AF50 M 1802 | AF50 T 01<br>AF50 ET 02<br>AF50 TH 03 | AF50 T 06 | AF50 M 1801 | AF50 T 07<br>AF50 ET 01<br>AF50 TH 04<br>AF50 M 1801 | AF50 T 09 |

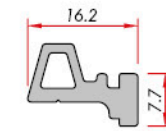

Panel Assembling Clips  
Kaset montaj Klipsi

| System Code | Profile No | Weight kg |
|-------------|------------|-----------|
| 1282        | 1282       | 0.215     |

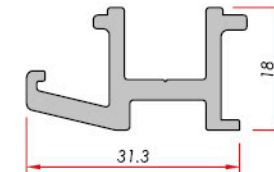

Panel Assembling Wedge  
Kaset Montaj Takozu

| System Code | Profile No | Weight kg |
|-------------|------------|-----------|
| 4417        | 4417       | 0.525     |

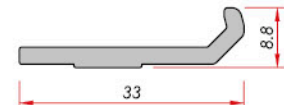

Glass Wedge  
Cam Takozu

| System Code | Profile No | Weight kg |
|-------------|------------|-----------|
| 1026        | 1026       | 0.269     |

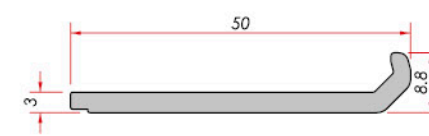

Glass Wedge  
Cam Takozu

| System Code | Profile No | Weight kg |
|-------------|------------|-----------|
| 1680        | 1680       | 0.442     |

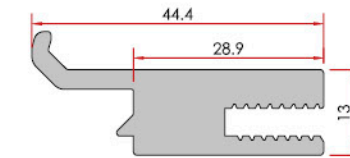

Glass Wedge  
Cam Takozu

| System Code | Profile No | Weight kg |
|-------------|------------|-----------|
| 0991        |            | 1.027     |

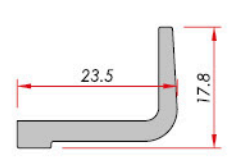

Glass Wedge  
Cam Takozu

| System Code | Profile No | Weight kg |
|-------------|------------|-----------|
| 1101        | 1101       | 0.284     |

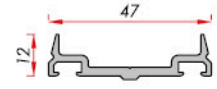

**Cover**  
Baskı Kapak

| System Code | Profile No | Weight kg |
|-------------|------------|-----------|
| AF50 C 05   | 1019       | 0.438     |

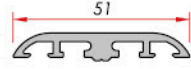

**Skylight Cover**  
Skylight Baskı Kapak

| System Code | Profile No | Weight kg |
|-------------|------------|-----------|
| AF50 C 06   | 1020       | 0.531     |

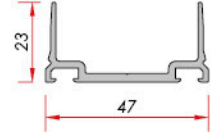

**Cover**  
Baskı Kapak

| System Code | Profile No | Weight kg |
|-------------|------------|-----------|
| AF50 C 11   | 1183       | 0.516     |

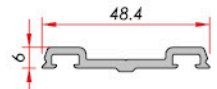

**Cover**  
Baskı Kapak

| System Code | Profile No | Weight kg/m |
|-------------|------------|-------------|
| AF50 C 14   | 1176       | 0.400       |

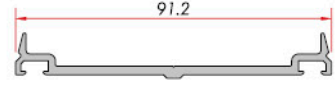

**Cover**  
Baskı Kapak

| System Code | Profile No | Weight kg/m |
|-------------|------------|-------------|
| AF50 C 17   | 1179       | 0.747       |

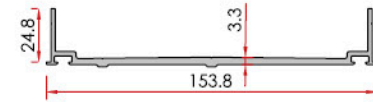

**Cover**  
Baskı Kapak

| System Code | Profile No | Weight kg/m |
|-------------|------------|-------------|
| AF50 C 22   | 1180       | 1.571       |

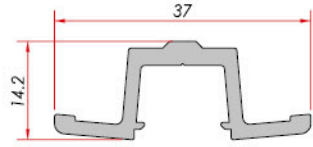

**Cover**  
Derz Kapak Profili

| System Code | Profile No | Weight kg/m |
|-------------|------------|-------------|
| AF50 A 05   | 1025       | 0.365       |

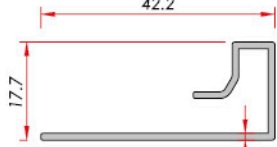

**Dilatation Profile**  
Dilatasyon Kapak

| System Code | Profile No | Weight kg |
|-------------|------------|-----------|
| AF50 A 02   | 1042       | 0.265     |

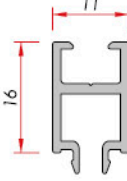

**Single Glass Bead**  
Tek Cam Çıtası

| System Code | Profile No | Weight kg |
|-------------|------------|-----------|
| AF50 A 03   | 1021       | 0.184     |

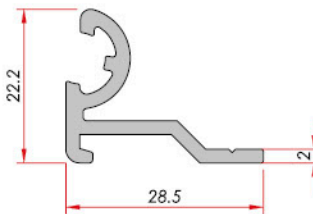

**Corner**  
Köşe Dönüş Dış

| System Code | Profile No | Weight kg |
|-------------|------------|-----------|
| AF50 A 06   | 1040       | 0.347     |

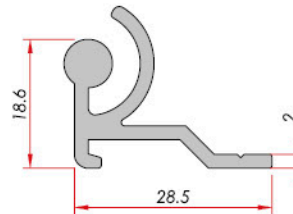

**Corner**  
Köşe Dönüş İç

| System Code | Profile No | Weight kg |
|-------------|------------|-----------|
| AF50 A 07   | 1041       | 0.350     |

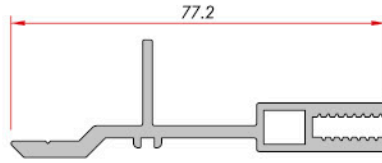

**Half Mullion Adapter**  
Yarım Mulyon Adaptörü

| System Code | Profile No | Weight kg |
|-------------|------------|-----------|
| AF50 A 01   | 1011       | 1.030     |

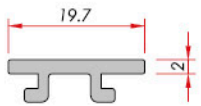

**Bonding Bead**  
Bonding Çıtası

| System Code | Profile No | Weight kg/m |
|-------------|------------|-------------|
| AF50 A 08   | 1043       | 0.154       |

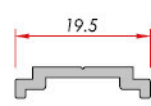

**Stem**  
Tij

| System Code | Profile No | Weight kg |
|-------------|------------|-----------|
| AF50 A 10   | 1375       | 0.126     |

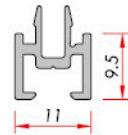

**Single Glass Bead**  
Tek Cam Çıtası

| System Code | Profile No | Weight kg |
|-------------|------------|-----------|
| AF50 A 12   | 1106       | 0.141     |

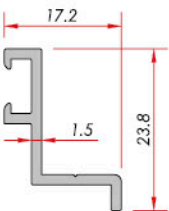

**Adaptor**  
Adaptör

| System Code | Profile No | Weight kg/m |
|-------------|------------|-------------|
| AF50 A 17   | 1182       | 0.182       |

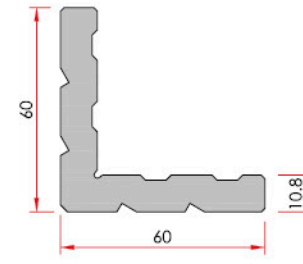

**Corner Cleat**  
Köşe Takozu

| System Code | Profile No | Weight kg |
|-------------|------------|-----------|
| 1034        | 1034       | 2.967     |

| Accessory Code | Profile Code | Cutting Size |
|----------------|--------------|--------------|
|----------------|--------------|--------------|

|               |  |         |
|---------------|--|---------|
| AKB-1034-8.5  | AF50 V 05 (1024)<br>AF50 V 19 (1024)<br>AF50 V 23 (1024)                     | 8.5 mm  |
| AKB-1034-12.5 | AF50 V 16 (1049)<br>AF50 V 12 (1131)   | 12.5 mm |
| AKB-1034-14.4 | AF50 V 10 (1109)   | 14.4 mm |
| AKB-1034-17.2 | AF50 V 15 (1151)<br>AF50 V 07 (1085)<br>AF50 V 11 (1121)                     | 17.2 mm |
| AKB-1034-25   | AF50 V 01 (1010)<br>AF50 V 02 (1045)<br>AF50 V 08 (1087)<br>AF50 V 14 (1150) | 25 mm   |
| AKB-1034-27   | AF50 V 15 (1151)<br>AF50 V 16 (1049)<br>AF50 V 07 (1085)<br>AF50 V 12 (1131) | 27 mm   |
| AKB-1034-31   | AF50 V 01 (1010)<br>AF50 V 05 (1024)<br>AF50 V 13 (1149)                     | 31 mm   |
| AKB-1034-45.5 | AF50 V 20 (1172)   | 45.5 mm |

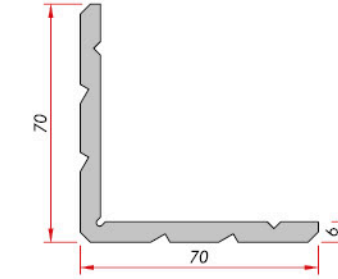

**Corner Cleat**  
Köşe Takozu

| System Code | Profile No | Weight kg |
|-------------|------------|-----------|
| 1097        | 1097       | 2.032     |

| Accessory Code | Profile Code | Cutting Size |
|----------------|--------------|--------------|
|----------------|--------------|--------------|

|               |  |         |
|---------------|--|---------|
| AKB-1097-9    | AF50 V 04 (1023)   | 9 mm    |
| AKB-1097-11   | AF50 V 03 (1022)   | 11 mm   |
| AKB-1097-14.5 | AF50 V 01 (1010)<br>AF50 V 23 (1048)                     | 14.5 mm |
| AKB-1097-22.5 | AF50 V 03 (1022)<br>AF50 V 09 (1096)<br>AF50 V 22 (1678) | 22.5 mm |
| AKB-1097-31   | AF50 V 14 (1150)<br>AF50 V 19 (1048)<br>AF50 V 23 (1048) | 31 mm   |
| AKB-1097-52   | AF50 V 21 (1171)   | 52 mm   |

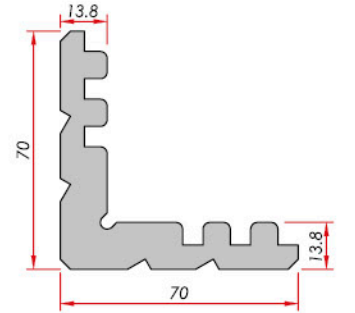

**Corner Cleat**  
Köşe Takozu

| System Code | Profile No | Weight kg |
|-------------|------------|-----------|
| 1328        | 1328       | 3.865     |

| System Code | Profile No | Cutting Size |
|-------------|------------|--------------|
|-------------|------------|--------------|

|             |                                      |       |
|-------------|--------------------------------------|-------|
| AKB-1028-13 | AF50 V 17 (1196)<br>AF50 V 18 (1197) | 13 mm |
|-------------|--------------------------------------|-------|

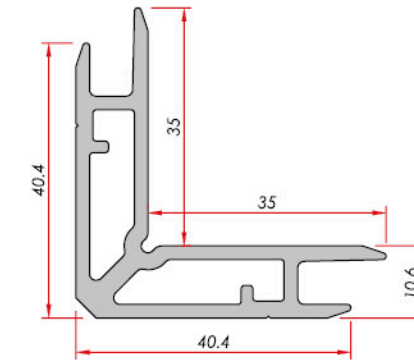

**Corner Cleat**  
Köşe Takozu

| System Code | Profile No | Weight kg |
|-------------|------------|-----------|
| 1297        | 1297       | 1.031     |

| System Code | Profile No | Cutting Size |
|-------------|------------|--------------|
|-------------|------------|--------------|

|               |                                      |         |
|---------------|--------------------------------------|---------|
| AKB-1034-12.5 | AF50 V 16 (1049)                     | 12.5 mm |
| AKB-1034-17.2 | AF50 V 15 (1151)<br>AF50 V 11 (1121) | 17.2 mm |
| AKB-1034-27   | AF50 V 15 (1151)<br>AF50 V 16 (1049) | 27 mm   |

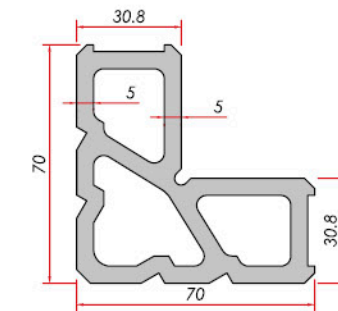

**Corner Cleat**  
Köşe Takozu

| System Code | Profile No | Weight kg |
|-------------|------------|-----------|
| 1329        | 1329       | 4.388     |

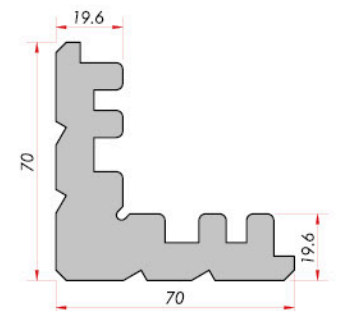





**Corner Cleat**  
Köşe Takozu



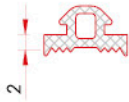
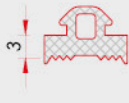
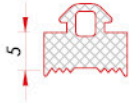
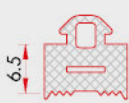

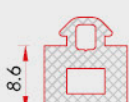
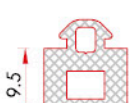

| System Code | Profile No | Weight kg |
|-------------|------------|-----------|
| 1730        | 1730       | 5.531     |

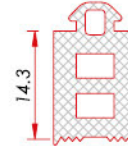
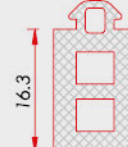
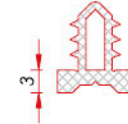
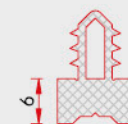
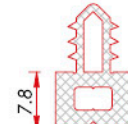
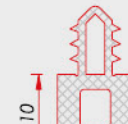
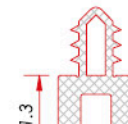
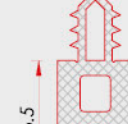

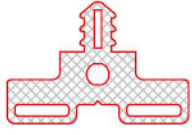
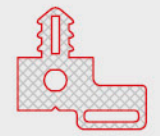
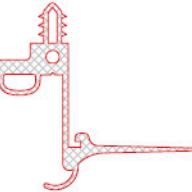

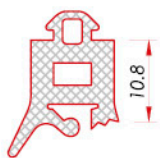

| System Code | Profile No | Cutting Size |
|-------------|------------|--------------|
|-------------|------------|--------------|

|             |             |       |
|-------------|-------------|-------|
| AKB-1730-12 | AKB-1730-12 | 12 mm |
|-------------|-------------|-------|

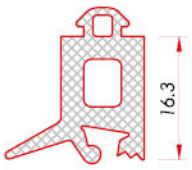
| CODE / KOD | ACCESSORIES / AKSESUAR  | DESCRIPTION / AÇIKLAMA |
|------------|---|------------------------|
| 01-1002    |    | 325-350 mt/Koli        |
| 01-1003    |    | 250 mt/Koli            |
| 01-1005    |    | 200 mt/Koli            |
| 01-1007    |   | 165 mt/Koli            |
| 01-1008    |  | 120 mt/Koli            |
| 01-1009    |  | 130 mt/Koli            |
| 01-1010    |  | 120 mt/Koli            |
| 01-1012    |  | 117 mt/Koli            |

| CODE / KOD | ACCESSORIES / AKSESUAR   | DESCRIPTION / AÇIKLAMA |
|------------|--|------------------------|
| 01-1014    |    | 83 mt/Koli             |
| 01-1016    |    | 75 mt/Koli             |
| 01-1103    |    | 230 mt/Koli            |
| 01-1106    |   | 145 mt/Koli            |
| 01-1108    |  | 135 mt/Koli            |
| 01-1110    |  | 125 mt/Koli            |
| 01-1111    |  | 100 mt/Koli            |
| 01-1117    |  | 75 mt/Koli             |

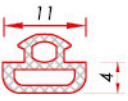
| CODE / KOD | ACCESSORIES / AKSESUAR  | DESCRIPTION / AÇIKLAMA |
|------------|---|------------------------|
| 01-1120    |    | 70 mt/Koli             |
| 01-1121    |    | 85 mt/Koli             |
| 01-1122    |    | 58 mt/Koli             |
| 01-1203    |   | 215 mt/Koli            |
| 01-1211    |  | 95 mt/Koli             |
| 01-1215    |  | 130 mt/Koli            |
| 01-1258    |  | 125 mt/Koli            |
| 01-1264    |  | 80 mt/Koli             |

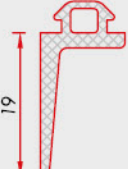
| CODE / KOD | ACCESSORIES / AKSESUAR  | DESCRIPTION / AÇIKLAMA |
|------------|---|------------------------|
| 01-1266    |    | 75 mt/Koli             |
| 01-1303    |    | 230 mt/Koli            |
| 01-1304    |    | 150 mt/Koli            |
| 01-1314    |   | 150 mt/Koli            |
| 01-1404    |  | 230-270 mt/Koli        |
| 01-1410    |  | 115 mt/Koli            |
| 01-1412    |  | 215 mt/Koli            |
| 01-1419    |  | 175 mt/Koli            |

| CODE / KOD | ACCESSORIES / AKSESUAR | DESCRIPTION / AÇIKLAMA |
|------------|------------------------|------------------------|
| 01-1431    |                        | 150 mt/Koli            |
| 01-1450    |                        | 270 mt/Koli            |
| 01-1451    |                        | 450 mt/Koli            |
| 01-1452    |                        | 250 mt/Koli            |
| 01-1453    |                        | 150 mt/Koli            |
| 01-1454    |                        | 175 mt/Koli            |
| 01-1457    |                        | 365 mt/Koli            |
| 01-1460    |                        | 115 mt/Koli            |
| 01-1503    |                        | 155 mt/Koli            |

| CODE / KOD | ACCESSORIES / AKSESUAR | DESCRIPTION / AÇIKLAMA |
|------------|------------------------|------------------------|
| 01-1505    |                        | 115 mt/Koli            |
| 01-1507    |                        | 95 mt/Koli             |
| 01-1510    |                        | 100 mt/Koli            |
| 01-1512    |                        | 75 mt/Koli             |
| 01-1514    |                        | 65 mt/Koli             |
| 01-1605    |                        | 90 mt/Koli             |
| 01-1615    |                        | 95 mt/Koli             |
| 01-1621    |                        | 65 mt/Koli             |
| 01-2033    |                        | 375 mt/Koli            |

| CODE / KOD | ACCESSORIES / AKSESUAR | DESCRIPTION / AÇIKLAMA  |
|------------|------------------------|---|
| 02-1001    |                        | 50 mt/Koli  |
| 02-1002    |                        | 100 mt/Koli   |
| 02-1101    |                        | 50 mt/Koli  |
| 03-1002    |                        | Transom Insulation Gasket<br>Transom Yalıtım Contası<br>1 Pack Contains 100 Pieces<br>1 Pakette 100 Adet            |
| 03-1003    |                        | Side Coverings<br>Badem Kapak Yan Kapamaları<br>1 Pack Contains 100 Pieces<br>1 Pakette 100 Adet                    |
| 03-1004    |                        | Side Coverings<br>Badem Kapak Yan Kapamaları<br>1 Pack Contains 100 Pieces<br>1 Pakette 100 Adet                    |
| 03-1065    |                        | 65mm Transom Dilatation Gasket<br>65 mm Transom Genleşme Contası<br>1 Pack Contains 50 Pieces<br>1 Pakette 50 Adet  |
| 03-1080    |                        | 80 mm Transom Dilatation Gasket<br>80 mm Transom Genleşme Contası<br>1 Pack Contains 50 Pieces<br>1 Pakette 50 Adet |

| CODE / KOD  | ACCESSORIES / AKSESUAR | DESCRIPTION / AÇIKLAMA  |    |   |   |   |   |   |   |    |   |   |   |    |   |    |   |    |   |    |   |    |   |    |   |    |   |    |  |  |
|---|------------------------|---|----|---|---|---|---|---|---|----|---|---|---|----|---|----|---|----|---|----|---|----|---|----|---|----|---|----|--|--|
| 03-1100   |                        | 100 mm<br>Transom Dilatation Gasket<br>100 mm<br>Transom Genleşme Contası<br>1 Pack Contains 50 Pieces<br>1 Pakette 50 Adet   |    |   |   |   |   |   |   |    |   |   |   |    |   |    |   |    |   |    |   |    |   |    |   |    |   |    |  |  |
| 03-1128   |                        | 128 mm<br>Transom Dilatation Gasket<br>128 mm<br>Transom Genleşme Contası<br>1 Pack Contains 50 Pieces<br>1 Pakette 50 Adet   |    |   |   |   |   |   |   |    |   |   |   |    |   |    |   |    |   |    |   |    |   |    |   |    |   |    |  |  |
| 03-1244   |                        | 244 mm<br>Transom Dilatation Gasket<br>244 mm<br>Transom Genleşme Contası<br>1 Pack Contains 50 Pieces<br>1 Pakette 50 Adet   |    |   |   |   |   |   |   |    |   |   |   |    |   |    |   |    |   |    |   |    |   |    |   |    |   |    |  |  |
| 03-2010   |                        | 12 mm Installation cap<br>12 mm Montaj Tapası<br>1 Pack Contains 100 Pieces<br>1 Pakette 100 Adet   |    |   |   |   |   |   |   |    |   |   |   |    |   |    |   |    |   |    |   |    |   |    |   |    |   |    |  |  |
| 03-2082<br>03-2084<br>03-2202<br>03-2203<br>03-2205<br>03-2252<br>03-2253<br>03-2255<br>03-2282<br>03-2283<br>03-2285 |                        | <table border="1"> <thead> <tr> <th>A</th> <th>B</th> <th>A</th> <th>B</th> </tr> </thead> <tbody> <tr> <td>2</td> <td>8</td> <td>3</td> <td>25</td> </tr> <tr> <td>4</td> <td>8</td> <td>5</td> <td>25</td> </tr> <tr> <td>2</td> <td>20</td> <td>2</td> <td>28</td> </tr> <tr> <td>3</td> <td>20</td> <td>3</td> <td>28</td> </tr> <tr> <td>5</td> <td>20</td> <td>5</td> <td>28</td> </tr> <tr> <td>2</td> <td>25</td> <td></td> <td></td> </tr> </tbody> </table> | A  | B | A | B | 2 | 8 | 3 | 25 | 4 | 8 | 5 | 25 | 2 | 20 | 2 | 28 | 3 | 20 | 3 | 28 | 5 | 20 | 5 | 28 | 2 | 25 |  |  |
| A   | B                      | A   | B  |   |   |   |   |   |   |    |   |   |   |    |   |    |   |    |   |    |   |    |   |    |   |    |   |    |  |  |
| 2   | 8                      | 3   | 25 |   |   |   |   |   |   |    |   |   |   |    |   |    |   |    |   |    |   |    |   |    |   |    |   |    |  |  |
| 4   | 8                      | 5   | 25 |   |   |   |   |   |   |    |   |   |   |    |   |    |   |    |   |    |   |    |   |    |   |    |   |    |  |  |
| 2   | 20                     | 2   | 28 |   |   |   |   |   |   |    |   |   |   |    |   |    |   |    |   |    |   |    |   |    |   |    |   |    |  |  |
| 3   | 20                     | 3   | 28 |   |   |   |   |   |   |    |   |   |   |    |   |    |   |    |   |    |   |    |   |    |   |    |   |    |  |  |
| 5   | 20                     | 5   | 28 |   |   |   |   |   |   |    |   |   |   |    |   |    |   |    |   |    |   |    |   |    |   |    |   |    |  |  |
| 2   | 25                     |   |    |   |   |   |   |   |   |    |   |   |   |    |   |    |   |    |   |    |   |    |   |    |   |    |   |    |  |  |
| 03-2310   |                        | Gutter<br>Çörten<br>1 Pack Contains 25 Pieces<br>1 Pakette 25 Adet  |    |   |   |   |   |   |   |    |   |   |   |    |   |    |   |    |   |    |   |    |   |    |   |    |   |    |  |  |
| 04-1001   |                        | Concealed Vent PVC Frame<br>Exterior<br>Gizli Kanat Kasa Plastiği Dış<br>Order Length: 3 mt<br>Sipariş Boyu 3 mt  |    |   |   |   |   |   |   |    |   |   |   |    |   |    |   |    |   |    |   |    |   |    |   |    |   |    |  |  |
|   |                        | Concealed Vent PVC Frame<br>Exterior<br>Gizli Kanat Kasa Plastiği Dış<br>Order Length: 3 mt<br>Sipariş Boyu 3 mt  |    |   |   |   |   |   |   |    |   |   |   |    |   |    |   |    |   |    |   |    |   |    |   |    |   |    |  |  |

| CODE / KOD | ACCESSORIES / AKSESUAR | DESCRIPTION / AÇIKLAMA   |
|------------|------------------------|--|
| 04-1003    |                        | Filling Silicone Strengthening (TPV)<br>Dolgu Silikonu Besleme Fitiği (TPV)                                |
| 04-1005    |                        | Mulyon-Transom Insulation PVC<br>Mulyon-Transom Yalıtım Plastiği<br>Order Length 3 mt<br>Sipariş Boyu 3 mt |
| 04-1011    |                        | Mulyon PVC Heat Insulation<br>Mulyon Isı Yalıtım Plastiği<br>Order Length 3 mt<br>Sipariş Boyu 3 mt        |
| 04-1019    |                        | Mulyon PVC Heat Insulation<br>Mulyon Isı Yalıtım Plastiği<br>Order Length 3 mt<br>Sipariş Boyu 3 mt        |
| 04-1029    |                        | Mulyon PVC Heat Insulation<br>Mulyon Isı Yalıtım Plastiği<br>Order Length 3 mt<br>Sipariş Boyu 3 mt        |
| 05-1001    |                        | (T) Connection<br>(T) Bağlantı<br>1 Pack Contains 50 Pieces<br>1 Pakette 50 Adet                           |
| 05-1002    |                        | Espagnolette Pin Counter<br>İspanyolet Pim Karşılığı<br>1 Pack Contains 50 Pieces<br>1 Pakette 50 Adet     |
| 05-1003    |                        | Adet   |

| CODE / KOD | ACCESSORIES / AKSESUAR | DESCRIPTION / AÇIKLAMA   |
|------------|------------------------|--|
| 06-1001    |                        | Cassette Side Holder<br>Kaset Yan Tutucu<br>1 Pack Contains 100 Pieces<br>1 Pakette 100 Adet                     |
| 06-1002    |                        | Cassette Side Holder<br>Kaset Yan Tutucu<br>1 Pack Contains 100 Pieces<br>1 Pakette 100 Adet                     |
| 06-1003    |                        | AF50 V01,02,05,08,13 Cassette Top Holder<br>Kaset Üst Tutucu<br>1 Pack Contains 100 Pieces<br>1 Pakette 100 Adet |
| 06-1004    |                        | AF50 V07,11,12 Cassette Top Holder<br>Kaset Üst Tutucu<br>1 Pack Contains 100 Pieces<br>1 Pakette 100 Adet       |
| 06-1005    |                        | AF50 V07,11,12,15,16 Cassette Holder<br>Kaset Tutucu<br>1 Pack Contains 100 Pieces<br>1 Pakette 100 Adet         |
| 06-1007    |                        | AF50 V07,11,12,15,16 Cassette Wedge<br>Kaset Takozu<br>1 Pack Contains 50 Pieces<br>1 Pakette 50 Adet            |
| 06-1008    |                        | AF50 V07,11,12,15,16 Cassette Wedge<br>Kaset Takozu<br>1 Pack Contains 50 Pieces<br>1 Pakette 50 Adet            |
| 06-1009    |                        | Surface 20 mic. Black Anodized<br>Yüzey 20 mic. Siyah Elokstal<br>1 Pack Contains 50 Pieces<br>1 Pakette 50 Adet |

| CODE / KOD | ACCESSORIES / AKSESUAR | DESCRIPTION / AÇIKLAMA   |
|------------|------------------------|--|
| 06-1010    |                        | Condense Channel -Dilatation Insulation Profile<br>Kondens Kanalı Dilatasyon Yalıtım Profili<br>1 Pack Contains 100 Pieces<br>1 Pakette 100 Adet |
| 06-1011    |                        | Condense Channel -Dilatation Insulation Profile<br>Kondens Kanalı Dilatasyon Yalıtım Profili<br>1 Pack Contains 100 Pieces<br>1 Pakette 100 Adet |
| 06-1012    |                        | Assembling Clips<br>Montaj Klipsi<br>1 Pack Contains 100 Pieces<br>1 Pakette 100 Adet  |
| 06-1013    |                        | External Corner Mounting Clips<br>Dış Köşe Montaj Klipsi<br>1 Pack Contains 100 Pieces<br>1 Pakette 100 Adet                                     |
| 06-1014    |                        | Assembling Clips Internal Corner<br>İç Köşe Montaj Klipsi<br>1 Pack Contains 100 Pieces<br>1 Pakette 100 Adet                                    |
| 06-1015    |                        | Assembling Angle Clips<br>Açılı Montaj Klipsi<br>1 Pack Contains 100 Pieces<br>1 Pakette 100 Adet  |
| 06-1133    |                        | Aluminium Glazing Cleat<br>Aluminyum Cam Takozu<br>1 Pack Contains 50 Pieces<br>1 Pakette 50 Adet  |
| 06-1150    |                        | Aluminium Glazing Cleat<br>Aluminyum Cam Takozu<br>1 Pack Contains 50 Pieces<br>1 Pakette 50 Adet  |

| CODE / KOD  | ACCESSORIES / AKSESUAR | DESCRIPTION / AÇIKLAMA   |
|---|------------------------|--|
| 06-1227   |                        | Aluminium Glazing Cleat<br>Aluminyum Cam Takozu<br>1 Pack Contains 50 Pieces<br>1 Pakette 50 Adet  |
| 06-1345   |                        | Aluminium Glazing Cleat<br>Aluminyum Cam Takozu<br>1 Pack Contains 50 Pieces<br>1 Pakette 50 Adet  |
| 09-1530<br>09-1531<br>09-1532<br>09-1533<br>09-1534 |                        | One Way Axial Handle<br>Tek Yöne Eksenel Kol<br>Anodizing / Nat. Elokstal<br>White / Beyaz<br>Brown / Kahverengi<br>Raw / Ham<br>Special / Özel Renk   |
| 09-1540<br>09-1541<br>09-1542<br>09-1543<br>09-1544 |                        | Dual Way Axial Handle<br>Çift Yöne Eksenel Kol<br>Anodizing / Nat. Elokstal<br>White / Beyaz<br>Brown / Kahverengi<br>Raw / Ham<br>Special / Özel Renk |
| 09-2700   |                        | Espagnolette Pin<br>İspanyolet Pimi<br>1 Pack Contains 50 Pieces<br>1 Pakette 50 Adet  |
| 09-2701   |                        | Corner Transfer Espagnolette<br>İspanyolet Köşe Aktarma<br>1 Pack Contains 30 Pieces<br>1 Pakette 30 Adet  |
| 10-1010   |                        | Anchorage Guide Tube<br>Ankraj Klavuz Borusu<br>1 Pack Contains 100 Pieces<br>1 Pakette 100 Adet   |
| 10-1015   |                        | Rockwool Of 80 Pins<br>80 lik Taş Yünü Çivisi<br>1 Pack Contains 100 Pieces<br>1 Pakette 100 Adet  |

| CODE / KOD | ACCESSORIES / AKSESUAR | DESCRIPTION / AÇIKLAMA  |
|------------|------------------------|---|
| 09-3000    |                        | Concealed Vent Facade Gizli Kanat Cephe Makası Takım (1 Takımda sağ ve sol olmak üzere 2 adet makas vardır.)<br>SPT22<br>567 mm<br>1090-1500 mm<br>75 Kg  |
| 09-3001    |                        | Concealed Vent Facade Gizli Kanat Cephe Makası Takım (1 Takımda sağ ve sol olmak üzere 2 adet makas vardır.)<br>SPT22W<br>567 mm<br>1090-1500 mm<br>75 Kg |
| 09-3002    |                        | Concealed Vent Facade Gizli Kanat Cephe Makası Takım (1 Takımda sağ ve sol olmak üzere 2 adet makas vardır.)<br>SPT26<br>682 mm<br>1090-2500 mm<br>180 Kg |
| 09-3003    |                        | Concealed Vent Facade Gizli Kanat Cephe Makası Takım (1 Takımda sağ ve sol olmak üzere 2 adet makas vardır.)<br>SPTH16<br>415 mm<br>1090-1500 mm<br>75 Kg |
| 09-3004    |                        | Concealed Vent Facade Gizli Kanat Cephe Makası Takım (1 Takımda sağ ve sol olmak üzere 2 adet makas vardır.)<br>SPT16<br>415 mm<br>787-1090 mm<br>55 Kg   |
| 09-3005    |                        | Concealed Vent Facade Gizli Kanat Cephe Makası Takım (1 Takımda sağ ve sol olmak üzere 2 adet makas vardır.)<br>SPT12<br>313 mm<br>635-787 mm<br>45 Kg    |

| CODE / KOD           | ACCESSORIES / AKSESUAR | DESCRIPTION / AÇIKLAMA   |
|----------------------|------------------------|--|
| 09-3010L<br>09-3010R |                        | Hinges Code Makas Kodu PX0350<br>Max. Vent Weight (Kg) Max. Kanat Ağırlığı 100<br>Min. Vent Height (mm) Min. Kanat Yüksekliği 350<br>Max. Vent Height (mm) Max. Kanat Yüksekliği 750<br>Max. Manual Opening Max. Manuel Açılım 150<br>Max. Motorised Opening Max. Motorlu Açılım 180<br>Manual Limit Stop Manuel Limit Stoplayıcı CB700  |
| 09-3011L<br>09-3011R |                        | Hinges Code Makas Kodu PX0450<br>Max. Vent Weight (Kg) Max. Kanat Ağırlığı 100<br>Min. Vent Height (mm) Min. Kanat Yüksekliği 450<br>Max. Vent Height (mm) Max. Kanat Yüksekliği 1000<br>Max. Manual Opening Max. Manuel Açılım 150<br>Max. Motorised Opening Max. Motorlu Açılım 250<br>Manual Limit Stop Manuel Limit Stoplayıcı CB571 |
| 09-3012L<br>09-3012R |                        | Hinges Code Makas Kodu PX0670<br>Max. Vent Weight (Kg) Max. Kanat Ağırlığı 200<br>Min. Vent Height (mm) Min. Kanat Yüksekliği 670<br>Max. Vent Height (mm) Max. Kanat Yüksekliği 1500<br>Max. Manual Opening Max. Manuel Açılım 150<br>Max. Motorised Opening Max. Motorlu Açılım 150<br>Manual Limit Stop Manuel Limit Stoplayıcı CB688 |
| 09-3013L<br>09-3013R |                        | Hinges Code Makas Kodu PX0950<br>Max. Vent Weight (Kg) Max. Kanat Ağırlığı 200<br>Min. Vent Height (mm) Min. Kanat Yüksekliği 930<br>Max. Vent Height (mm) Max. Kanat Yüksekliği 2000<br>Max. Manual Opening Max. Manuel Açılım 150<br>Max. Motorised Opening Max. Motorlu Açılım 250<br>Manual Limit Stop Manuel Limit Stoplayıcı CB571 |

| CODE / KOD | ACCESSORIES / AKSESUAR | DESCRIPTION / AÇIKLAMA  |
|------------|------------------------|---|
| 10-1100    |                        | Steel Anchorage 100<br>100 lük Çelik Ankraj<br>Pieces<br>Adet   |
| 10-1125    |                        | Steel Anchorage 125<br>125 lük Çelik Ankraj<br>Pieces<br>Adet   |
| 10-1150    |                        | Steel Anchorage 150<br>150 lük Çelik Ankraj<br>Pieces<br>Adet   |
| 10-1200    |                        | Transom Installation Model<br>Transom Montaj Şablonu  |
| 10-1201    |                        | Mulyon Side Template Holder<br>Mulyon Yan Tutucu Şablonu<br>SPTH16<br>415 mm<br>1090-1500 mm<br>75 Kg |

| CODE / KOD                               | ACCESSORIES / AKSESUAR | DESCRIPTION / AÇIKLAMA   |
|--|------------------------|--|
| 10-1202                                  |                        | Frame Side Holder Model<br>Kaset Yan Tutucu Şablonu  |
| 10-1203                                  |                        | Frame Bottom Holder Model<br>Kaset Alt Tutucu Şablonu  |
| 10-1300                                  |                        | Aluminium Foil Tape<br>Aluminyum Folyo Bant<br>Pieces (10mt)<br>Adet (10mt)  |
| 10-3000<br>10-3001<br>10-3002<br>10-3003 |                        | Standart Filling Silicone<br>1 Pack Contains 25 Pieces<br>Genel Amaçlı Dolgu Silikonu<br>1 Paketde 25 Adet<br>Grey / Gri<br>Transparent / Şeffaf<br>White / Beyaz<br>Black / Siyah |
| 10-3010<br>10-3011<br>10-3012<br>10-3013 |                        | Neutral Filling Silicone 1 Pack<br>Contains 25 Pieces<br>Nötr Dolgu Silikonu<br>1 Paketde 25 Adet<br>Grey / Gri<br>Transparent / Şeffaf<br>White / Beyaz<br>Black / Siyah          |

**ISO 9001 SERTİFİKASI**



**QUALICOAT SERTİFİKASI**



**QUALANOD SERTİFİKASI**

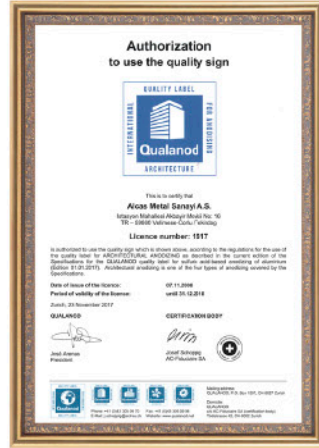

**IATF 16949 SERTİFİKASI**



**TSE HASSAS PROFİLLER BELGESİ**



**TSE YÜZEY İŞLEM BELGESİ**



**TSE İMALATI YETERLİLİK BELGESİ**



**ISO 14001**



**OHSAS 18001 BELGESİ**



**FABRİKA ÜRETİM UYGUNLUK**



**CE BELGESİ**



**GOST-R SERTİFİKASI**



# ALCAS®

ALUMINIUM PROFILE SYSTEMS

444 36 44

alcas@alcas.com.tr

www.alcas.com.tr

Kaya Milenium Plaza Kat 7 No:139 Beykent / İstanbul +90212 871 1771

Velimeşe Islah OSB 129.Sok.11/1 Ergene / Tekirdağ +90282 674 5175

alcasmetal

alcasaluminyum

alcasmetal

alcasmetal

alcasmetal



All designs, profiles and accessories listed in this catalog are © copyrighted and ® registered products. May not be copied, altered or posted online by any means.  
Bu katalogta yer alan tasarımlar, profiller ve aksesuarlar tescilli ve patentli ürünlerimizdir. Hiçbir şekilde kopyalanamaz ve taktit edilemez.

*Dünyanın yeni profil sistemi*

